

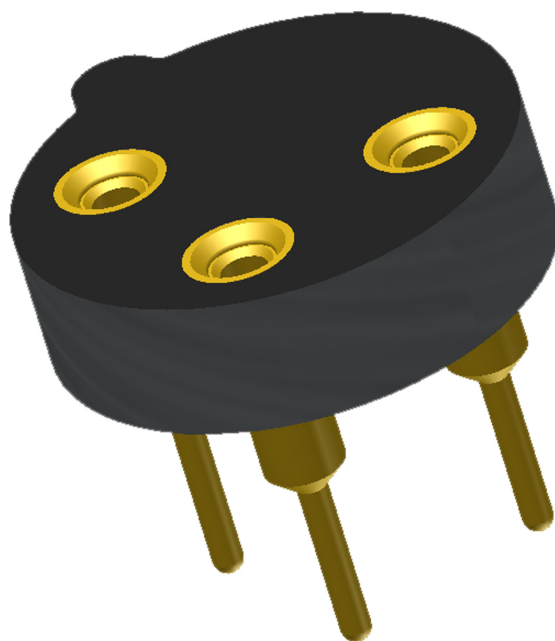

RoHS Compliant  
ISO 9001  
Certified

## **HIGH RELIABILITY OPTOELECTRONIC SOCKETS FOR**

# **Panasonic®**



***Featuring Andon's Unique Senstac™ Contact***

PANASONIC INDUSTRIAL DEVICES is a trade mark of PANASONIC INDUSTRIAL DEVICES

PANASONIC INDUSTRIAL DEVICES						
PANASONIC INDUSTRIAL DEVICES Model Number	Andon Part Number Replace "XXX" with Terminal Type	Terminal Type		Pin Ø [in]	Figure Number	Page Number
		Thru-Hole	Surface Mount			
NAPION SERIES STANDARD TYPE	R200-0403-02T-XXX-R27-L14	01S	93S	.018	1	1
NAPION SERIES SLIGHT MOTION DETECTION TYPE	R200-0403-02T-XXX-R27-L14	01S	93S	.018	1	1
NAPION SERIES SPOT DETECTION TYPE	R200-0403-02T-XXX-R27-L14	01S	93S	.018	1	1
NAPION SERIES 10M DETECTION TYPE	R200-0403-02T-XXX-R27-L14	01S	93S	.018	1	1
VZ SERIES WL SERIES STANDARD TYPE	R200-0403-02T-XXX-R27-L14	01S	93S	.018	1	1
VZ SERIES WL SERIES LONG DISTANCE DETECTION TYPE	R200-0403-02T-XXX-R27-L14	01S	93S	.018	1	1

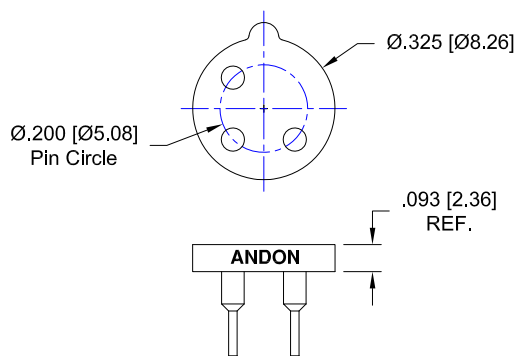

**Fig. 01**

Thru-Hole: R200-0403-02T-**01S**-R27-L14  
Surface Mount: R200-0403-02T-**93S**-R27-L14

## Technical Information

### Material:

Insulator: Hi-Temp UL 94V-O  
Terminal: Brass, per ASTM-B16  
Contact: BeCu, Per ASTM-B194

### Plating: RoHS COMPLIANT

**R15 TERMINAL: GOLD / CONTACT: GOLD**

**R17 TERMINAL: TIN / CONTACT: GOLD**

**OTHER PLATINGS AVAILABLE**

Terminal Acceptance and Forces							
Thru Hole Terminals				Surface Mount Terminals			
Thru Hole Terminal	Accepts Pin Diameter	Insertion Force	Withdrawal Force	Surface Mount Terminal	Accepts Pin Diameter	Insertion Force	Withdrawal Force
<b>-01S</b>	Ø.018 [Ø0.46]	9.0 oz Avg.	2.0 oz Min	<b>-93S</b>	Ø.018 [Ø0.46]	9.0 oz Avg.	2.0 oz Min

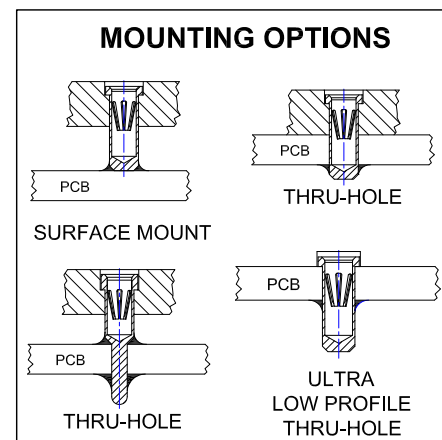

**"ANDON PROPRIETARY INFORMATION"**

**RoHS Compliant**

©Copyright 2016 Andon Electronics Corporation. All Rights Reserved. This material is protected under US and other copyrights and may not be copied, sold, or redistributed in any form without written permission of Andon Electronics Corporation. Copyrights and trademarks are property of their respective companies. We reserve the right to change specifications without notice. Andon makes no warranty, expressed or implied, as to the suitability of the sockets for the intended purpose.

\*Sockets are not drawn to scale PANASONIC INDUSTRIAL DEVICES 3/9/2016

**ANDON ELECTRONICS CORPORATION**  
4 Court Drive, Lincoln RI 02865, United States of America

[www.andonelectronics.com](http://www.andonelectronics.com) or [www.andonelect.com](http://www.andonelect.com)  
Phone 401-333-0388 Fax 401-333-0287  
Email [Info@andonelect.com](mailto:Info@andonelect.com)