

ADVANCED CRYSTAL TECHNOLOGY						
Advanced Crystal Technology Model Number	Andon Part Number Replace "XXX" with Terminal Type	Terminal Type		Pin Ø [in]	Figure Number	Page Number
		Thru-Hole	Surface Mount			
ACTF139	C10-004-04-01-XXX-R27-L14	01S	93S	.018	16	5
ACTF147	C10-004-04-01-XXX-R27-L14	01S	93S	.018	16	5
ACTF155	C10-004-04-01-XXX-R27-L14	01S	93S	.018	16	5
ACTF163	C10-004-04-01-XXX-R27-L14	01S	93S	.018	16	5
ACTF171	C10-004-04-01-XXX-R27-L14	01S	93S	.018	16	5
ACTF233/233.15/F16	C10-004-04-01-XXX-R27-L14	01S	93S	.018	16	5
ACTF280	C10-004-04-01-XXX-R27-L14	01S	93S	.018	16	5
ACTF36BWS/36.125/SIP5V	C10-005-05-01-XXX-R27-L14	01S	93S	.018	24	6
ACTF433E	R200-0403-03T-XXX-R27-L14	01S	93S	.018	23	6
ACTF46-49	R196-SP05-01T-XXX-R27-L14	295V	439V	.030	32	8
ACTF465B/465.0/F11	C10-004-04-01-XXX-R27-L14	01S	93S	.018	16	5
ACTF480-6	R200-0404-01T-XXX-R27-L14	01S	93S	.018	26	7
ACTF59-14	R200-0404-01T-XXX-R27-L14	01S	93S	.018	26	7
ACTF7010	C10-314-04-01-XXX-R27-L14	01S	93S	.018	7	3
ACTFF374S	R200-0403-05T-XXX-R27-L14	01S	93S	.018	22	6
ACTF930.5	C10-004-04-01-XXX-R27-L14	01S	93S	.018	16	5
ACTF916.5	C10-004-04-01-XXX-R27-L14	01S	93S	.018	16	5
ACT HC49/TA SERIES	C196-002-02-01-XXX-R27-L14	01S	93S	.018	14	5
ACT HC49/UM1	C15-02-02-01-XXX-R27-L14	274K	281K	.018	13	4
ACT HC49/US	C192-002-02-01-XXX-R27-L14	01S	93S	.018	9	4
ACT SPXO 08/14	C10-314-04-01-XXX-R27-L14	01S	93S	.018	7	3
ACTQ434	C10-004-04-01-XXX-R27-L14	01S	93S	.018	16	5
ACTQ868.3D	R200-0403-03T-XXX-R27-L14	01S	93S	.018	23	6
ACTR303	C10-004-04-01-XXX-R27-L14	01S	93S	.018	16	5
ACTR868.35	C10-004-04-01-XXX-R27-L14	01S	93S	.018	16	5
ACTR980	R200-0403-03T-XXX-R27-L14	01S	93S	.018	16	5
ACTX3032D-T/36.20/SIP5V	C10-005-05-01-XXX-R27-L14	01S	93S	.018	28	7
ACT1100HS	C10-314-04-01-XXX-R27-L14	01S	93S	.018	7	3
ACT1700HS	C10-308-04-02-XXX-R27-L14	01S	93S	.018	4	3
ACT3000-VCTCXO PACK 2	C10-314-04-03-XXX-R27-L14	433E	285E	.040	5	3
ACT3000-VCTCXO PACK 4	C10-314-04-03-XXX-R27-L14	433E	285E	.040	5	3
ACT3000-VCTCXO PACK 9	C10-606-05-01-XXX-R27-L14	01S	93S	.018	2	3
ACT3A01T PACK 1	C10-314-04-01-XXX-R27-L14	01S	93S	.018	7	3
ACT3A01T PACK 2	C10-314-04-01-XXX-R27-L14	01S	93S	.018	7	3
ACT3A01T PACK 3	C10-314-04-01-XXX-R27-L14	01S	93S	.018	7	3
ACT3A01T PACK 4	C10-314-04-02-XXX-R27-L14	295V	439V	.030	3	3
ACT3A04T PACK 1	C10-314-04-01-XXX-R27-L14	01S	93S	.018	7	3
ACT3A04T PACK 2	C10-314-04-01-XXX-R27-L14	01S	93S	.018	7	3
ACT3A04T PACK 3	C10-314-04-01-XXX-R27-L14	01S	93S	.018	7	3
ACT3A04T PACK 4	C10-314-04-02-XXX-R27-L14	295V	439V	.030	3	3
ACT3A11T PACK 1	C10-314-04-01-XXX-R27-L14	01S	93S	.018	7	3
ACT3A11T PACK 4	C10-314-04-02-XXX-R27-L14	295V	439V	.030	3	3
ACT7000-7007 VCXO	C10-314-04-01-XXX-R27-L14	01S	93S	.018	7	3
ACT7A01-VCXO PACK 1	C10-314-04-01-XXX-R27-L14	01S	93S	.018	7	3
ACT7A01-VCXO PACK 2	C10-308-04-02-XXX-R27-L14	01S	93S	.018	4	3
ACT7VC14	C10-314-03-01-XXX-R27-L14	01S	93S	.018	6	3
F-11	C10-004-04-01-XXX-R27-L14	01S	93S	.018	16	5
F16	C10-004-04-01-XXX-R27-L14	01S	93S	.018	16	5
HC49U: 13.5	C096-003-03-01-XXX-R27-L14	01S	93S	.018	1	3
M1	CSP807-02-01-XXX-R27-L14	433E	285E	.040	33	8
M2	CSP470-05-01-XXX-R27-L14	295V	439V	.030	27	7
NDW-4	R750-1204-01T-XXX-R27-L14	295V	439V	.030	21	6
OC14BA	C10-314-04-01-XXX-R27-L14	01S	93S	.018	7	3
OC14BB	C10-314-04-01-XXX-R27-L14	01S	93S	.018	7	3
OC14BST	C10-314-04-01-XXX-R27-L14	01S	93S	.018	7	3
OC14BVA	C10-314-04-01-XXX-R27-L14	01S	93S	.018	7	3
OC20B	C10-606-05-01-XXX-R27-L14	01S	93S	.018	2	3
OC20C	C10-606-05-01-XXX-R27-L14	01S	93S	.018	2	3
OC20S3	C10-606-05-01-XXX-R27-L14	01S	93S	.018	2	3
OC25 16	C10-7524-05-01-XXX-R27-L14	295V	439V	.030	30	7

ADVANCED CRYSTAL TECHNOLOGY						
Advanced Crystal Technology Model Number	Andon Part Number Replace "XXX" with Terminal Type	Terminal Type		Pin Ø [in]	Figure Number	Page Number
		Thru-Hole	Surface Mount			
SF712	C10-004-04-01-XXX-R27-L14	01S	93S	.018	16	5
SIP5K	C10-005-05-02-XXX-R27-L14	295V	439V	.030	24	6
SIP5T	C10-005-05-01-XXX-R27-L14	01S	93S	.018	28	7
TE SERIES	C098-003-03-01-XXX-R27-L14	01S	93S	.018	8	4
TH/TL SA, SB SERIES	C098-003-03-01-XXX-R27-L14	01S	93S	.018	8	4
TO39	R200-0403-03T-XXX-R27-L14	01S	93S	.018	23	6
TO-39-2	R200-0403-05T-XXX-R27-L14	01S	93S	.018	22	6
TO39-3	R200-0404-01T-XXX-R27-L14	01S	93S	.018	26	7
U, T, Ux2, Tx2	C096-003-03-01-XXX-R27-L14	01S	93S	.018	8	4
U1, U5, U1S, U5S	C074-003-03-01-XXX-R27-L14	274K	281K	.018	11	4
OC38R	C10-1020-04-02-XXX-R27-L14	433E	285E	.040	15	5
OC50	C10-1514-07-02-XXX-R27-L14	295V	439V	.030	12	4
OC50B	C10-1514-07-01-XXX-R27-L14	433E	285E	.040	10	4
OC50DO	C10-1634-05-02-XXX-R27-L14	433E	285E	.040	31	7
OC50RL	C10-1634-05-02-XXX-R27-L14	433E	285E	.040	31	7
PACKAGE 11	C10-314-04-01-XXX-R27-L14	01S	93S	.018	7	3
PACKAGE 20	IS229-304-XXX-R29-L14	01S	93S	.018	29	7
OC2525	C10-7524-05-01-XXX-R27-L14	295V	439V	.030	30	7
OC253	C10-7524-05-01-XXX-R27-L14	295V	439V	.030	30	7
OC25BS	C10-7524-05-01-XXX-R27-L14	295V	439V	.030	30	7
OC25BSL	C10-7524-05-01-XXX-R27-L14	295V	439V	.030	30	7
OC25L 11.0	C10-7524-05-01-XXX-R27-L14	295V	439V	.030	30	7
OC25R 12.5	C10-7524-05-01-XXX-R27-L14	295V	439V	.030	30	7
OC36A/AL	C10-1014-05-02-XXX-R27-L14	295V	439V	.030	20	6
OC36B/BL/BH	C10-1014-05-02-XXX-R27-L14	295V	439V	.030	20	6
OC36CT	C10-1014-05-02-XXX-R27-L14	295V	439V	.030	20	6
OC381	C125-1018-05-01-XXX-R27-L14	295V	439V	.030	19	7
OC3838	C10-1114-05-02-XXX-R27-L14	295V	439V	.030	17	7
OC38B	C10-10610-06-01-XXX-R27-L14	295V	439V	.030	18	7
OC38BR	C10-1113-05-02-XXX-R27-L14	295V	439V	.030	25	6

## Advanced Crystal Technology Continued

### Socket Terminal Details

Cross Section View Shown Units: in [mm]

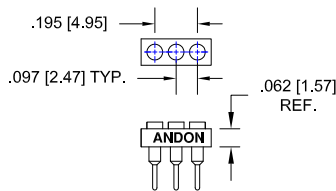

**Fig. 1**

Thru-Hole: C096-003-03-01-01S-R27-L14

Surface Mount: C096-003-03-01-93S-R27-L14

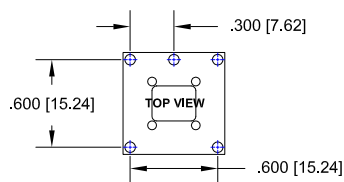

**Fig. 2**

Thru-Hole: C10-606-05-01-01S-R27-L14

Surface Mount: C10-606-05-01-93S-R27-L14

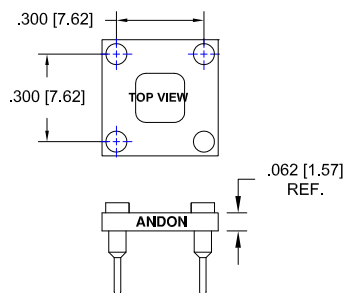

**Fig. 4**

Thru-Hole: C10-308-04-02-01S-R27-L14

Surface Mount: C10-308-04-02-93S-R27-L14

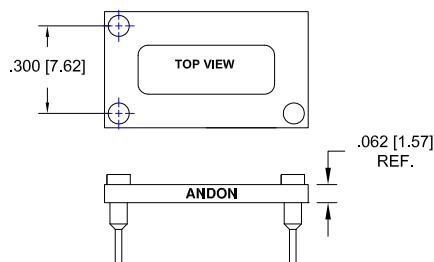

**Fig. 6**

Thru-Hole: C10-314-03-01-01S-R27-L14

Surface Mount: C10-314-03-01-93S-R27-L14

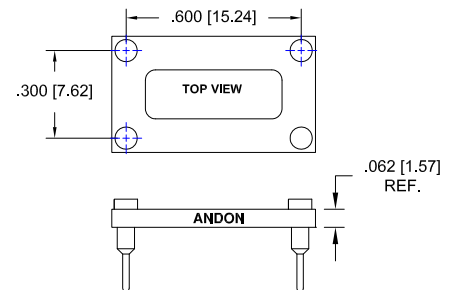

**Fig. 3**

Thru-Hole: C10-314-04-02-295V-R27-L14

Surface Mount: C10-314-04-02-439V-R27-L14

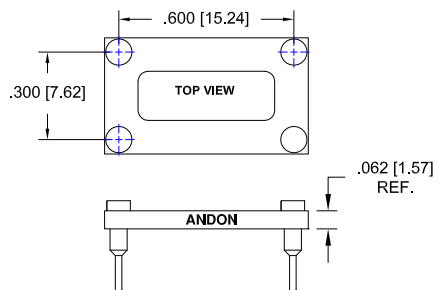

**Fig. 5**

Thru-Hole: C10-314-04-03-433E-R27-L14

Surface Mount: C10-314-04-03-285E-R27-L14

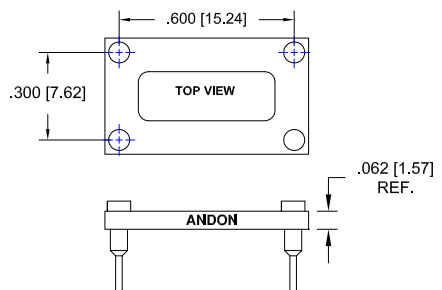

**Fig. 7**

Thru-Hole: C10-314-04-01-01S-R27-L14

Surface Mount: C10-314-04-01-93S-R27-L14

## Advanced Crystal Technology Continued

### Socket Terminal Details

Cross Section View Shown Units: in [mm]

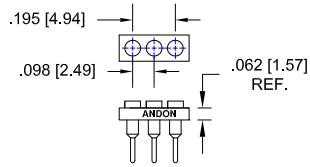

**Fig.8**

Thru-Hole: C098-003-03-01-**01S**-R27-L14  
Surface Mount: C098-003-03-01-**93S**-R27-L14

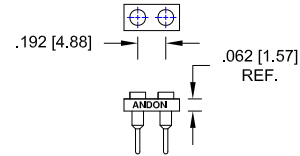

**Fig.9**

Thru-Hole: C192-002-02-01-**01S**-R27-L14  
Surface Mount: C192-002-02-01-**93S**-R27-L14

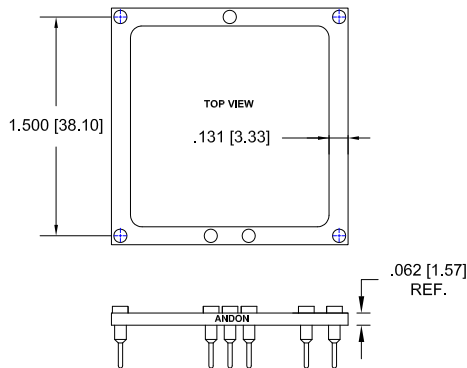

**Fig.10**

Thru-Hole: C10-1514-07-01-**433E**-R27-L14  
Surface Mount: C10-1514-07-01-**285E**-R27-L14

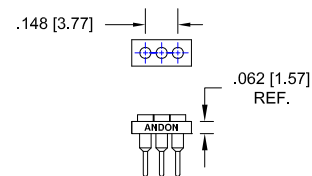

**Fig.11**

Thru-Hole: C074-003-03-01-**274K**-R27-L14  
Surface Mount: C074-003-03-01-**281K**-R27-L14

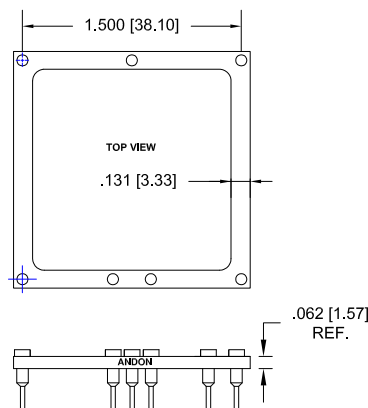

**Fig.12**

Thru-Hole: C10-1514-07-02-**295V**-R27-L14  
Surface Mount: C10-1514-07-02-**439V**-R27-L14

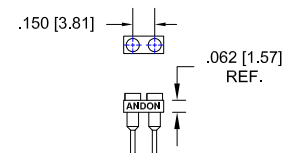

**Fig.13**

Thru-Hole: C15-02-02-01-**274K**-R27-L14  
Surface Mount: C15-02-02-01-**281K**-R27-L14

## Advanced Crystal Technology Continued

### Socket Terminal Details

Cross Section View Shown Units: in [mm]

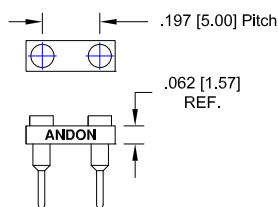

**Fig. 14**

Thru-Hole: C196-002-02-01-01S-R27-L14  
Surface Mount: C196-002-02-01-93S-R27-L14

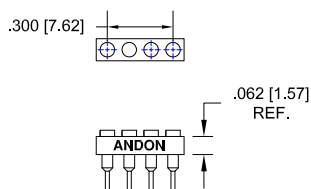

**Fig. 16**

Thru-Hole: C10-004-04-01-01S-R27-L14  
Surface Mount: C10-004-04-01-93S-R27-L14

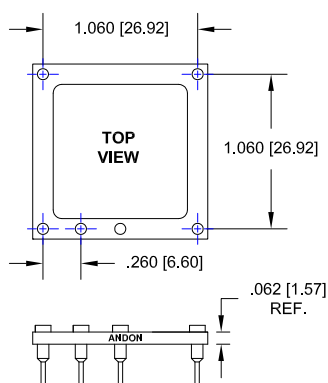

**Fig. 18**

Thru-Hole: C10-10610-06-01-295V-R27-L14  
Surface Mount: C10-10610-06-01-439V-R27-L14

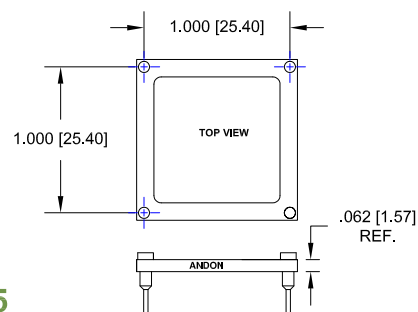

**Fig. 15**

Thru-Hole: C10-1020-04-02-433E-R27-L14  
Surface Mount: C10-1020-04-02-285E-R27-L14

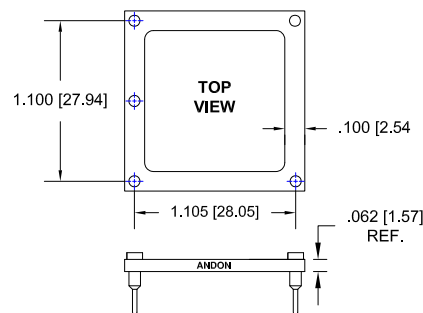

**Fig. 17**

Thru-Hole: C10-1114-05-02-295V-R27-L14  
Surface Mount: C10-1114-05-02-439V-R27-L14

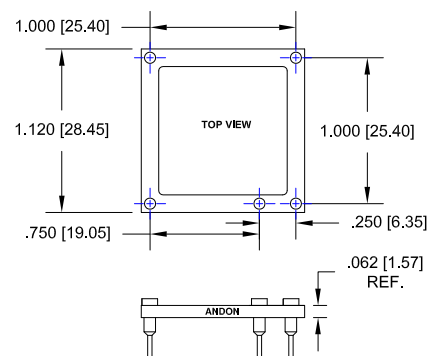

**Fig. 19**

Thru-Hole: C125-1018-05-01-295V-R27-L14  
Surface Mount: C125-1018-05-01-439V-R27-L14

## Advanced Crystal Technology Continued

### Socket Terminal Details

Cross Section View Shown Units: in [mm]

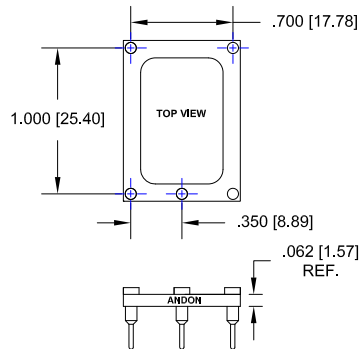

**Fig.20**

Thru-Hole: C10-1014-05-02-**295V**-R27-L14  
Surface Mount: C10-1014-05-02-**439V**-R27-L14

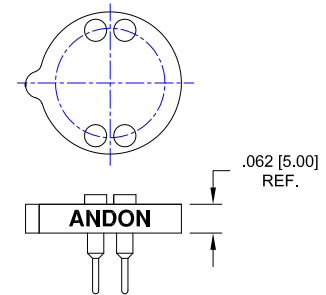

**Fig.21**

Thru-Hole: R750-1204-01T-**295V**-R27-L14  
Surface Mount: R750-1204-01T-**439V**-R27-L14

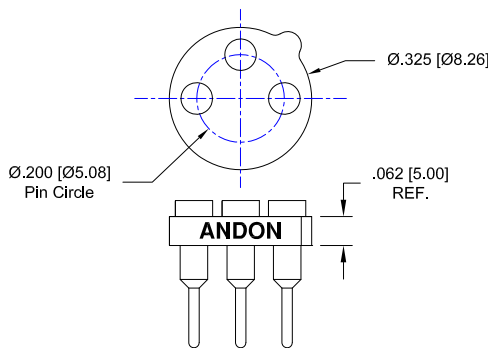

**Fig.22**

Thru-Hole: R200-0403-05T-**01S**-R27-L14  
Surface Mount: R200-0403-05T-**93S**-R27-L14

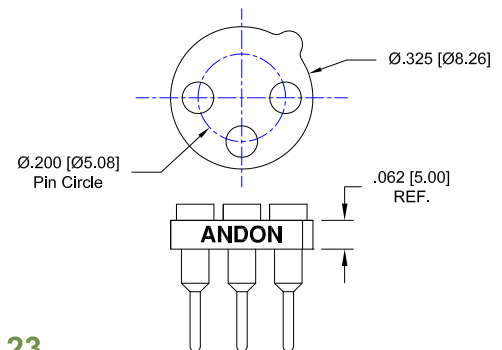

**Fig.23**

Thru-Hole: R200-0403-03T-**01S**-R27-L14  
Surface Mount: R200-0403-03T-**93S**-R27-L14

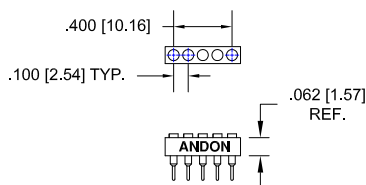

**Fig.24**

Thru-Hole: C10-005-05-02-**295V**-R27-L14  
Surface Mount: C10-005-05-02-**439V**-R27-L14

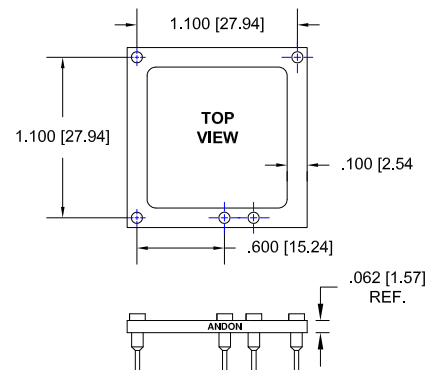

**Fig.25**

Thru-Hole: C10-1113-05-02-**295V**-R27-L14  
Surface Mount: C10-1113-05-02-**439V**-R27-L14

## Advanced Crystal Technology Continued

### Socket Terminal Details

Cross Section View Shown Units: in [mm]

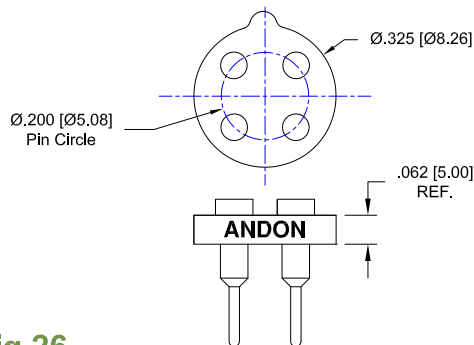

**Fig.26**

Thru-Hole: R200-0404-01T-**01S**-R27-L14  
Surface Mount: R200-0404-01T-**93S**-R27-L14

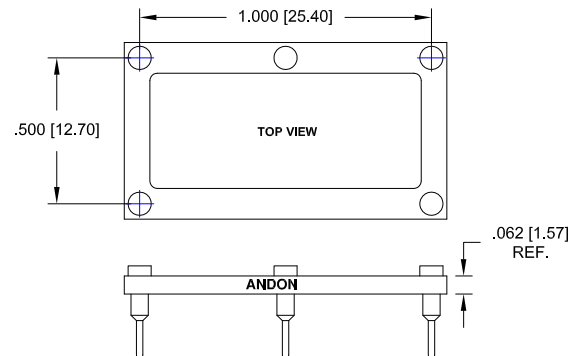

**Fig.27**

Thru-Hole: CSP470-05-01-**295V**-R27-L14  
Surface Mount: CSP470-05-01-**439V**-R27-L14

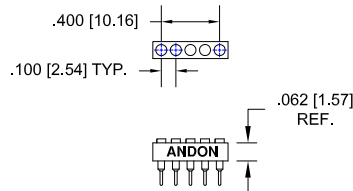

**Fig.28**

Thru-Hole: C10-005-05-01-**01S**-R27-L14  
Surface Mount: C10-005-05-01-**93S**-R27-L14

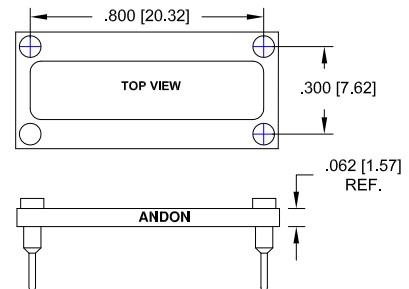

**Fig.29**

Thru-Hole: IS229-304-**01S**-R29-L14  
Surface Mount: IS229-304-**93S**-R29-L14

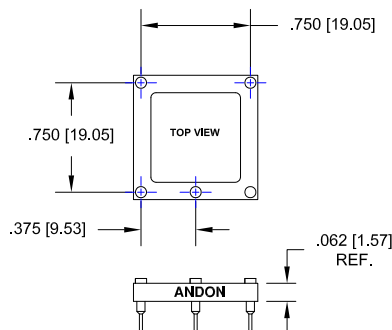

**Fig.30**

Thru-Hole: C10-7524-05-01-**295V**-R27-L14  
Surface Mount: C10-7524-05-01-**439V**-R27-L14

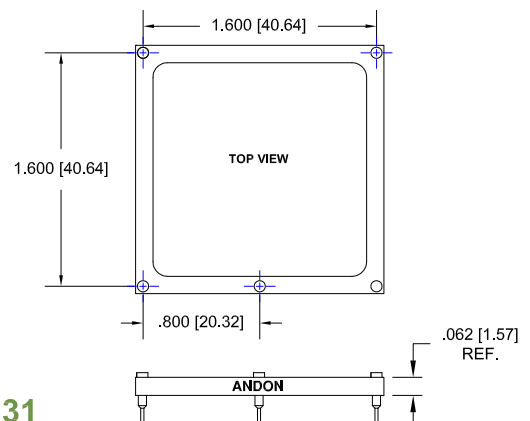

**Fig.31**

Thru-Hole: C10-1634-05-02-**433E**-R27-L14  
Surface Mount: C10-1634-05-02-**285E**-R27-L14

## Advanced Crystal Technology Continued

### Socket Terminal Details

Cross Section View Shown Units: in [mm]

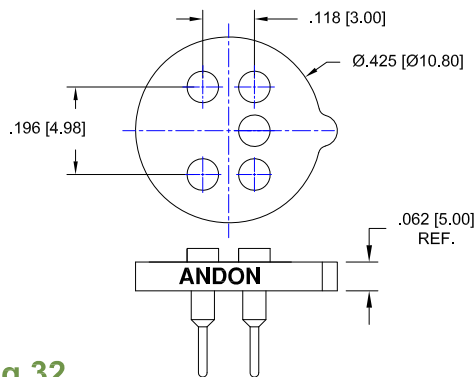

**Fig.32**

Thru-Hole: R196-SP05-01T-295V-R27-L14  
Surface Mount: R196-SP05-01T-439V-R27-L14

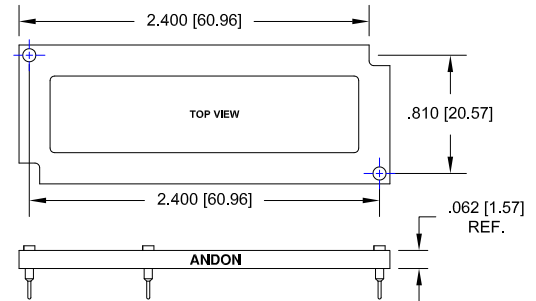

**Fig.33**

Thru-Hole: CSP807-02-01-304-433E-R27-L14  
SurfaceMount: CSP807-02-01-304-285E-R27-L14



## Advanced Crystal Technology *Continued*

### Socket Terminal Details Cross Section View Shown Units: in [mm]

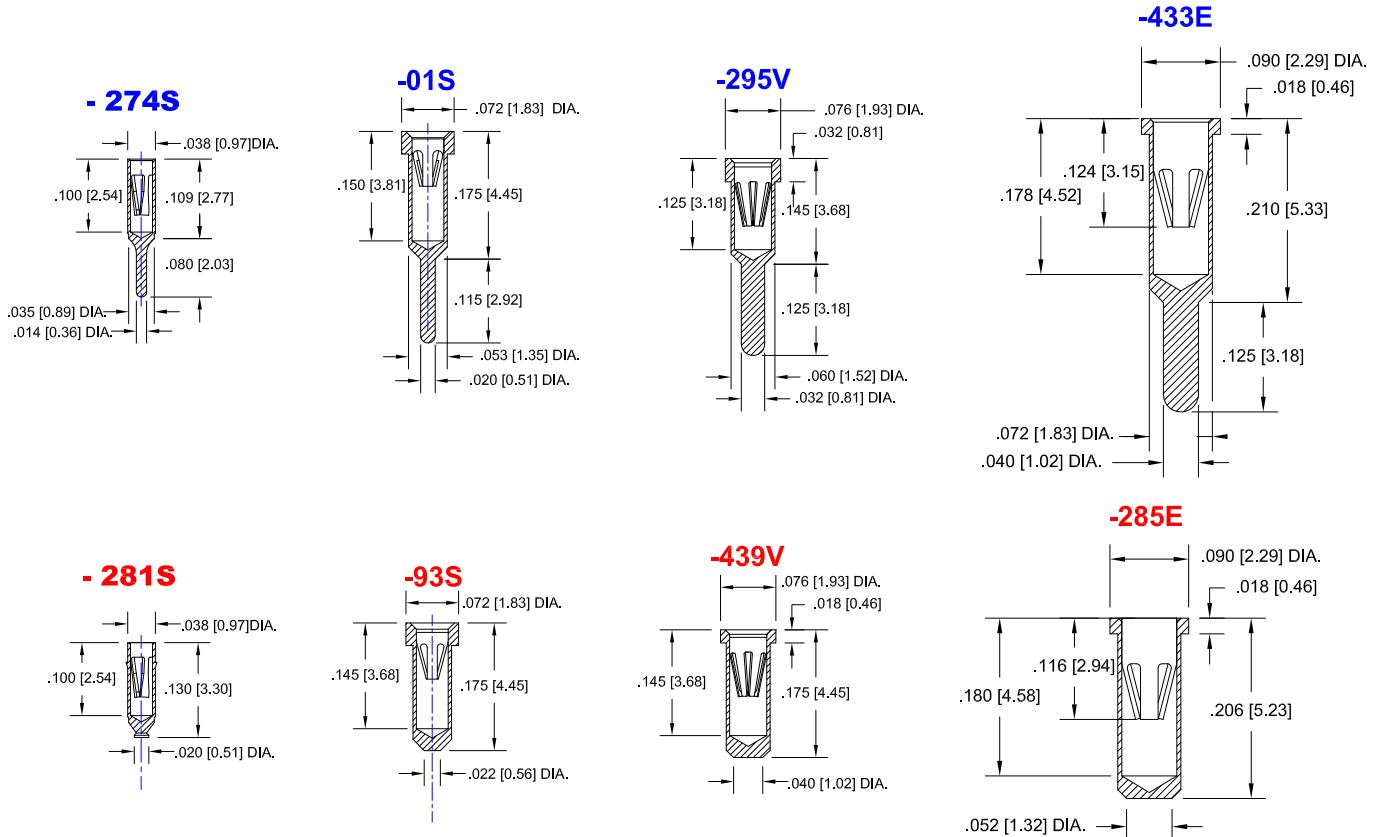

## Technical Information

### Material:

Insulator: Hi-Temp UL 94V-O  
 Terminal: Brass, per ASTM-B16  
 Contact: BeCu, Per ASTM-B194

### Plating: RoHS COMPLIANT

R15 TERMINAL: GOLD / CONTACT: GOLD

R17 TERMINAL: TIN / CONTACT: GOLD

OTHER PLATINGS AVAILABLE

Terminal Acceptance and Forces							
Thru Hole Terminals				Surface Mount Terminals			
Thru Hole Terminal	Accepts Pin Diameter	Insertion Force	Withdrawal Force	Surface Mount Terminal	Accepts Pin Diameter	Insertion Force	Withdrawal Force
-01S	Ø.018 [Ø0.46]	9.0 oz Avg.	2.0 oz Min	-93S	Ø.018 [Ø0.46]	9.0 oz Avg.	2.0 oz Min
-295V	Ø.030 [Ø0.76]	13.2 oz Max	3.5 oz Min	-439V	Ø.030 [Ø0.76]	13.2 oz Max	3.5 oz Min
-433E	Ø.040 [Ø1.02]	36.0 oz Max	3.9 oz Min	-285E	Ø.040 [Ø1.02]	36.0 oz Max	3.9 oz Min
-274K	Ø.018 [Ø0.46]	1.0 oz Max	0.3 oz Min	-281K	Ø.018 [Ø0.46]	1.0 oz Max	0.3 oz Min

### MOUNTING OPTIONS

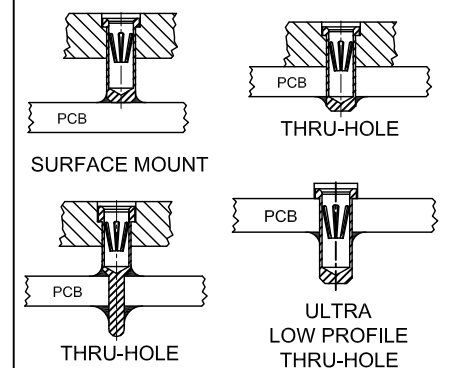

"ANDON PROPRIETARY INFORMATION"

RoHS Compliant

©Copyright 2015 Andon Electronics Corporation. All Rights Reserved. This material is protected under US and other copyrights and may not be copied, sold, or redistributed in any form without written permission of Andon Electronics Corporation. Copyrights and trademarks are property of their respective companies. We reserve the right to change specifications without notice. Andon makes no warranty, expressed or implied, as to the suitability of the sockets for the intended purpose.

\*Sockets are not drawn to scale Advanced Crystal Technology 04/10/2015

**ANDON ELECTRONICS CORPORATION**  
 4 Court Drive, Lincoln RI 02865, United States of America

www.andonelectronics.com or www.andonelect.com  
 Phone 401-333-0388 Fax 401-333-0287  
 Email Info@andonelect.com