

PRECISION DEVICES INC.						
PRECISION DEVICES INC. Model Number	Andon Part Number Replace "XXX" with Terminal Type	Terminal Type		Pin Ø [in]	Figure Number	Page Number
		Thru-Hole	Surface Mount			
U1-SERIES	CSP148-02-01-XXX-R27-L14	400T4	414T4	.012	7	3
CR72/U SERIES	CSP192-02-01-XXX-R27-L14	01S	93S	.018	8	3
CR60/U SERIES	CSP192-02-01-XXX-R27-L14	01S	93S	.018	8	3
CR67/U SERIES	CSP192-02-01-XXX-R27-L14	01S	93S	.018	8	3
CR64/U SERIES	CSP192-02-01-XXX-R27-L14	01S	93S	.018	8	3
CR69/U SERIES	CSP192-02-01-XXX-R27-L14	01S	93S	.018	8	3
CR76/U SERIES	CSP192-02-01-XXX-R27-L14	01S	93S	.018	8	3
CR97/U SERIES	CSP192-02-01-XXX-R27-L14	01S	93S	.018	8	3
CR106/U SERIES	CSP192-02-01-XXX-R27-L14	01S	93S	.018	8	3
CR55/U SERIES	CSP192-02-01-XXX-R27-L14	01S	93S	.018	8	3
CR61/U SERIES	CSP192-02-01-XXX-R27-L14	01S	93S	.018	8	3
HA SERIES	CSP192-02-01-XXX-R27-L14	01S	93S	.018	8	3
H3 SERIES	C486-002-02-01-XXX-R27-L14	295V	439V	.030	11	3
CR89/U SERIES	CSP192-02-02-XXX-R27-L14	433E	285E	.040	3	2
CR117/U SERIES	CSP192-02-02-XXX-R27-L14	433E	285E	.040	3	2
CR79/U SERIES	CSP192-02-02-XXX-R27-L14	433E	285E	.040	3	2
CR81/U SERIES	CSP192-02-02-XXX-R27-L14	433E	285E	.040	3	2
CR77/U SERIES	CSP192-02-02-XXX-R27-L14	433E	285E	.040	3	2
CR78/U SERIES	CSP192-02-02-XXX-R27-L14	433E	285E	.040	3	2
CR84/U SERIES	CSP192-02-02-XXX-R27-L14	433E	285E	.040	3	2
CR85/U SERIES	C486-002-02-02-XXX-R27-L14	436P55	440P55	.060	5	2
CR119/U SERIES	C482-002-02-02-XXX-R27-L14	436P55	440P55	.060	5	2
CR125/U SERIES	C486-002-02-02-XXX-R27-L14	436P55	440P55	.060	5	2
CR130/U SERIES	C482-002-02-02-XXX-R27-L14	436P55	440P55	.060	5	2
CR157/U SERIES	C486-002-02-02-XXX-R27-L14	436P55	440P55	.060	5	2
CR18/U SERIES	C482-002-02-02-XXX-R27-L14	436P55	440P55	.060	5	2
CR19/U SERIES	C486-002-02-02-XXX-R27-L14	436P55	440P55	.060	5	2
CR27/U SERIES	C482-002-02-02-XXX-R27-L14	436P55	440P55	.060	5	2
CR28/U SERIES	C486-002-02-02-XXX-R27-L14	436P55	440P55	.060	5	2
CR35/U SERIES	C482-002-02-02-XXX-R27-L14	436P55	440P55	.060	5	2
CR5/U SERIES	C486-002-02-02-XXX-R27-L14	436P55	440P55	.060	5	2
CR58/U SERIES	C482-002-02-02-XXX-R27-L14	436P55	440P55	.060	5	2
CR6/U SERIES	C486-002-02-02-XXX-R27-L14	436P55	440P55	.060	5	2
CR62/U SERIES	C482-002-02-02-XXX-R27-L14	436P55	440P55	.060	5	2
CR8/U SERIES	C486-002-02-02-XXX-R27-L14	436P55	440P55	.060	5	2
CR101/U-SERIES	R200-0403-05T-XXX-R27-L14	01S	93S	.018	1	2
LCT1-SERIES	405-02-XXX-R27-L14	01S	93S	.018	12	3
VN01-SERIES	C10-1014-05-02-XXX-R27-L14	295V	439V	.030	13	3
LCT2-SERIES	CSP1260-06-01-XXX-R27-L14	295V	439V	.030	10	3
VC20-SERIES	C10-314-04-01-XXX-R27-L14	01S	93S	.018	9	3
014-SERIES	C10-314-04-01-XXX-R27-L14	01S	93S	.018	9	3
VC08-SERIES	C10-308-04-02-XXX-R27-L14	01S	93S	.018	4	2
O08-SERIES	C10-308-04-02-XXX-R27-L14	01S	93S	.018	4	2
VN03-SERIES	C10-7524-05-01-XXX-R27-L14	295V	439V	.030	2	2
MIL-55310/08-SERIES	C10-314-14-01-XXX-R27-L14	01S	93S	.018	6	2
MIL-55310/25-SERIES	C10-314-14-01-XXX-R27-L14	01S	93S	.018	6	2
MIL-55310/26-SERIES	C10-314-14-01-XXX-R27-L14	01S	93S	.018	6	2
MIL-55310/18-SERIES	C10-314-14-01-XXX-R27-L14	01S	93S	.018	6	2
MIL-55310/17-SERIES	C10-314-14-01-XXX-R27-L14	01S	93S	.018	6	2
MIL-55310/16-SERIES	C10-314-14-01-XXX-R27-L14	01S	93S	.018	6	2
MIL-55310/14-SERIES	C10-314-14-01-XXX-R27-L14	01S	93S	.018	6	2
MIL-55310/26-SERIES	C10-314-04-01-XXX-R27-L14	01S	93S	.018	9	3
MIL-55310/25-SERIES	C10-314-04-01-XXX-R27-L14	01S	93S	.018	9	3

(FIG.1) PRECISION DEVICES INC.	ANDON PART NUMBER
	THRU-HOLE: R200-0403-05T-01S-R27-L14 SURFACE MOUNT: R200-0403-05T-93S-R27-L14

CR101/U-SERIES

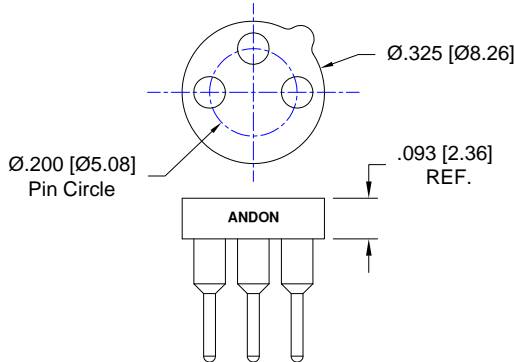

(FIG.2) PRECISION DEVICES INC.	ANDON PART NUMBER
	THRU-HOLE: C10-7524-05-01-295V-R27-L14 SURFACE MOUNT: C10-7524-05-01-439V-R27-L14

VN03-SERIES

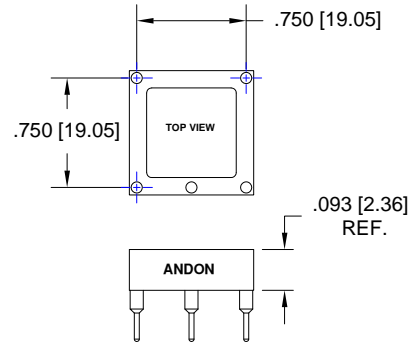

(FIG.3) PRECISION DEVICES INC.	ANDON PART NUMBER
	THRU-HOLE: CSP192-02-02-433E-R27-L14 SURFACE MOUNT: CSP192-02-02-285E-R27-L14

CR89/U-SERIES
CR117/U-SERIES
CR79/U-SERIES
CR81/U-SERIES
CR77/U-SERIES
CR78/U-SERIES
CR84/U-SERIES

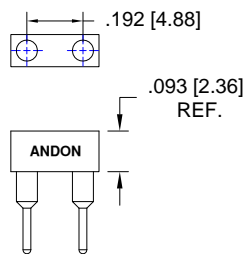

(FIG.4) PRECISION DEVICES INC.	ANDON PART NUMBER
	THRU-HOLE: C10-308-04-02-01S-R27-L14 SURFACE MOUNT: C10-308-04-02-93S-R27-L14

VC08-SERIES
O08-SERIES

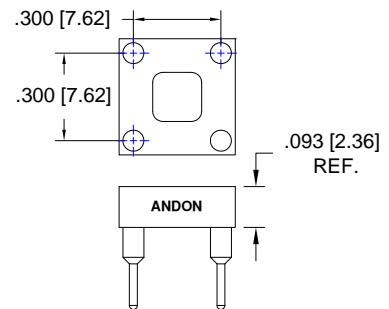

(FIG.5) PRECISION DEVICES INC.	ANDON PART NUMBER
	THRU-HOLE: C486-002-02-02-436P55-R27-L14 SURFACE MOUNT: C486-002-02-02-440P55-R27-L14

CR85/U-SERIES
CR119/U-SERIES
CR125/U-SERIES
CR130/U-SERIES
CR157/U-SERIES
CR18/U-SERIES
CR19/U-SERIES
CR27/U-SERIES
CR28/U-SERIES
CR35/U-SERIES
CR5/U-SERIES
CR58/U-SERIES
CR6/U-SERIES
CR62/U-SERIES
CR8/U-SERIES

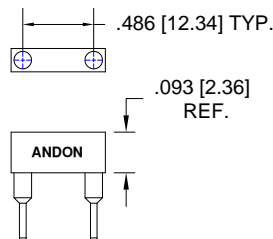

(FIG.6) PRECISION DEVICES INC.	ANDON PART NUMBER
	THRU-HOLE: C10-314-14-01-01S-R27-L14 SURFACE MOUNT: C10-314-01-93S-R27-L14

MIL-55310/08-SERIES
MIL-55310/25-SERIES
MIL-55310/26-SERIES
MIL-55310/18-SERIES
MIL-55310/17-SERIES
MIL-55310/16-SERIES
MIL-55310/14-SERIES

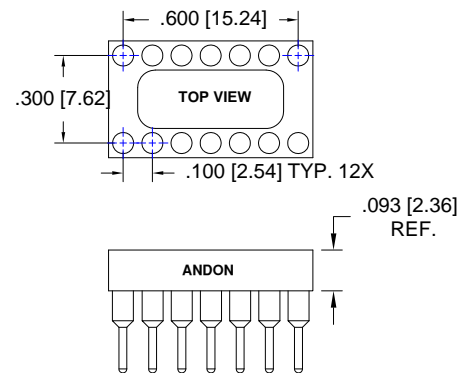

(FIG.7) PRECISION DEVICES INC.	ANDON PART NUMBER
	THRU-HOLE: CSP148-02-01-400T4-R27-L14 SURFACE MOUNT: CSP148-02-01-414T4-R27-L14

U1-SERIES

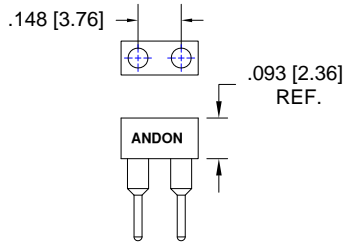

(FIG.8) PRECISION DEVICES INC.	ANDON PART NUMBER
	THRU-HOLE: CSP192-02-01-01S-R27-L14 SURFACE MOUNT: CSP192-02-01-93S-R27-L14

CR72/U-SERIES
CR60/U-SERIES
CR67/U-SERIES
CR64/U-SERIES
CR69/U-SERIES
CR76/U-SERIES
CR97/U-SERIES
CR106/U-SERIES
CR55/U-SERIES
CR61/U-SERIES
HA SERIES

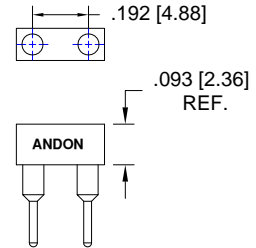

(FIG.9) PRECISION DEVICES INC.	ANDON PART NUMBER
	THRU-HOLE: C10-314-04-01-01S-R27-L14 SURFACE MOUNT: C10-314-04-01-93S-R27-L14

VC20-SERIES
014-SERIES
MIL-55310/26-SERIES
MIL-55310/25-SERIES

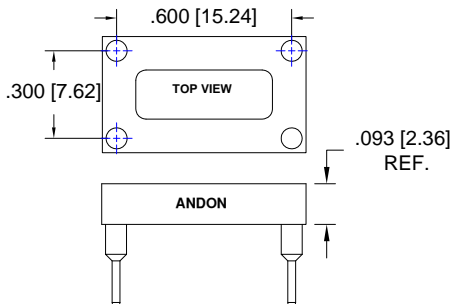

(FIG.10) PRECISION DEVICES INC.	ANDON PART NUMBER
	THRU-HOLE: CSP1260-06-01-295V-R27-L14 SURFACE MOUNT: CSP1260-06-01-439V-R27-L14

LCT2-SERIES

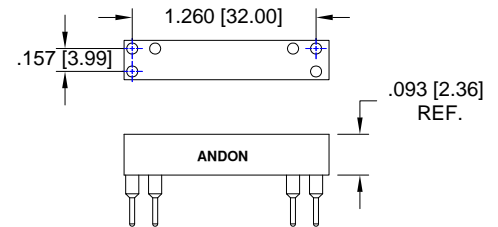

(FIG.11) PRECISION DEVICES INC.	ANDON PART NUMBER
	THRU-HOLE: C486-002-02-01-295V-R27-L14 SURFACE MOUNT: C486-002-01-439V-R27-L14

H3 SERIES

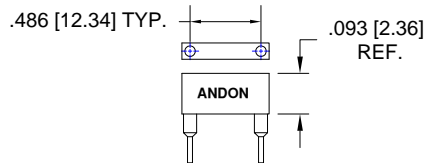

(FIG.12) PRECISION DEVICES INC.	ANDON PART NUMBER
	THRU-HOLE: 405-02-01S-R27-L14 SURFACE MOUNT: 405-02-93S-R27-L14

LCT1-SERIES

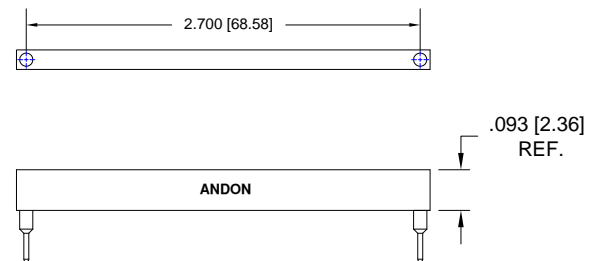

(FIG.13) PRECISION DEVICES INC.	ANDON PART NUMBER
	THRU-HOLE: C10-1014-05-02-295V-R27-L14 SURFACE MOUNT: C10-1014-05-02-439V-R27-L14

VN01-SERIES

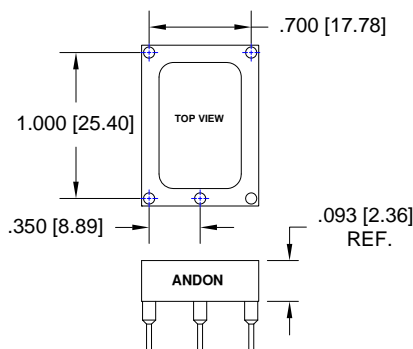

PRECISION DEVICES INC.						
PRECISION DEVICES INC. Model Number	Andon Part Number Replace "XXX" with Terminal Type	Terminal Type		Pin Ø [in]	Figure Number	Page Number
		Thru-Hole	Surface Mount			
VC07-SERIES	605D-06B-SM-G10-L14-X	-	-	-	14	4
VC29-3-SERIES	606D-04B-SM-G10-L14-X	-	-	-	17	4
MFCS1	620D-12A-SM-G10-L14-X	-	-	-	15	4
OC5-SERIES	605D-04B-SM-G10-L14-X	-	-	-	16	4
LV7-SERIES	605D-06B-SM-G10-L14-X	-	-	-	14	4

Fig. 14

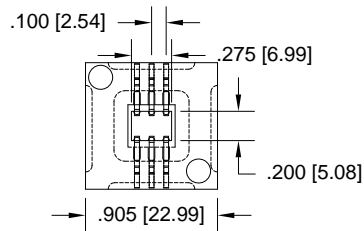

Fig. 15

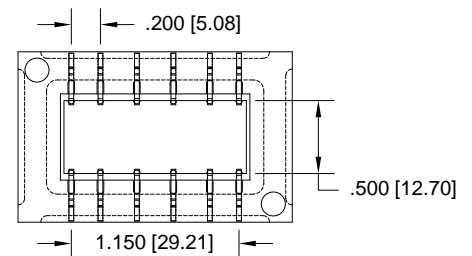

Fig. 16

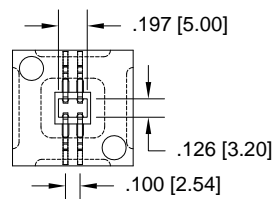
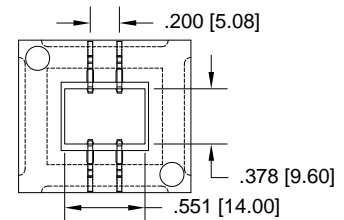
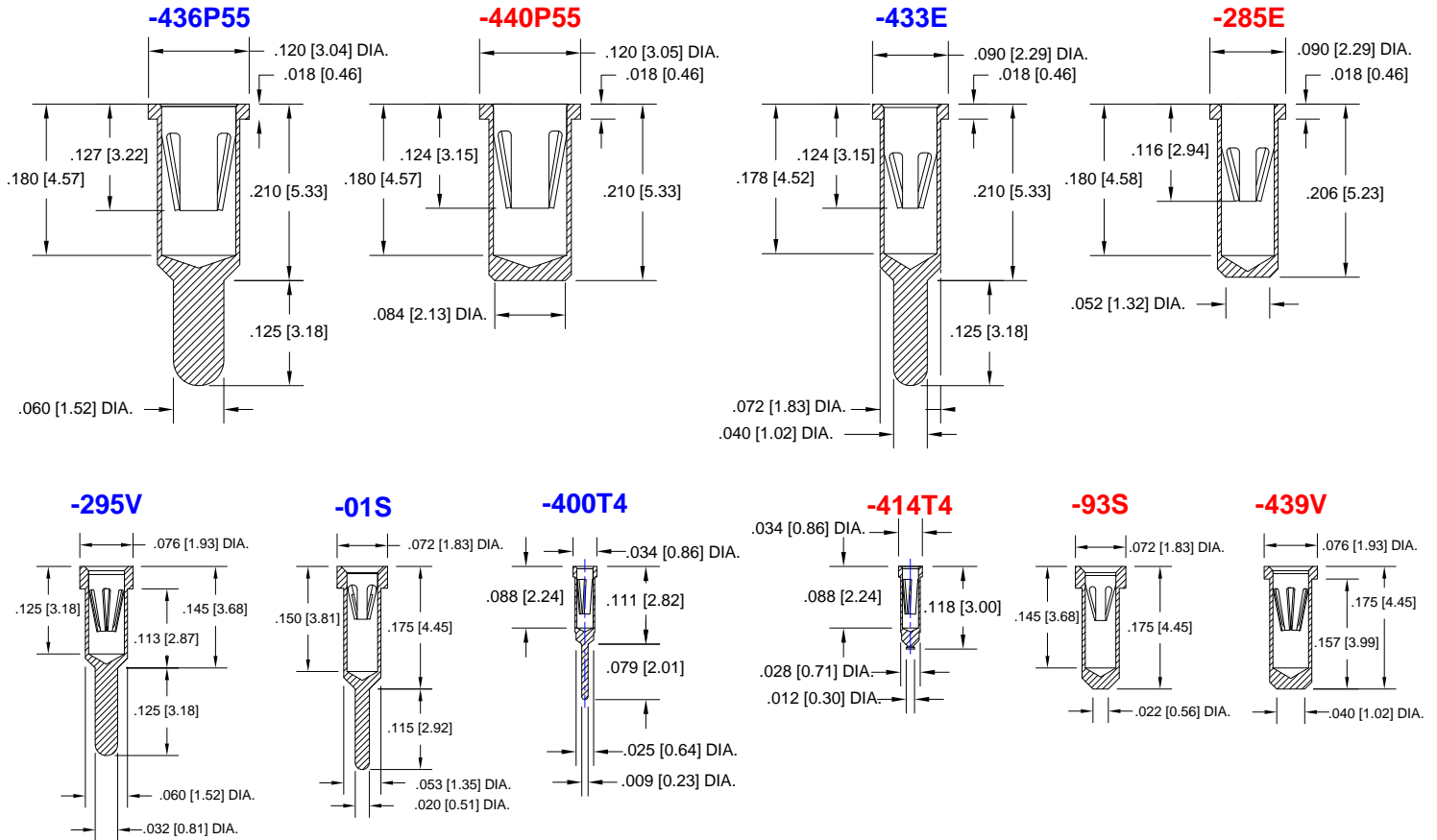

Fig. 17





Technical Information

Material:

Insulator: Hi-Temp UL 94V-0
Terminal: Brass, per ASTM-B16
Contact: BeCu, Per ASTM-B194

Plating: RoHS COMPLIANT

R15 TERMINAL: GOLD / CONTACT: GOLD

R17 TERMINAL: TIN / CONTACT: GOLD

OTHER PLATINGS AVAILABLE

Terminal Acceptance and Forces

Thru Hole Terminals				Surface Mount Terminals			
Thru Hole Terminal	Accepts Pin Diameter	Insertion Force	Withdrawal Force	Surface Mount Terminal	Accepts Pin Diameter	Insertion Force	Withdrawal Force
-433E	Ø .040 [Ø1.02]	36.0 oz Max	3.9 oz Min	-285E	Ø .040 [Ø1.02]	36.0 oz Max	3.9 oz Min
-436P55	Ø .060 [Ø1.52]	15.5 oz Max	2.1 oz Min	-440P55	Ø .060 [Ø1.52]	15.5 oz Max	2.1 oz Min
-400T4	Ø .012 [Ø0.30]	1.1 oz Max	0.3 oz Min	-414T4	Ø .012 [Ø0.30]	1.1 oz Max	0.3 oz Min
-01S	Ø .018 [Ø0.46]	9.0 oz Max	2.0 oz Min	-93S	Ø .018 [Ø0.46]	9.0 oz Max	2.0 oz Min
-295V	Ø .030 [Ø0.76]	13.2 oz Max	3.5 oz Min	-439V	Ø .030 [Ø0.76]	13.2 oz Max	3.5 oz Min

MOUNTING OPTIONS

