

RAKON AMERICA LLC						
RAKON AMERICA LLC Model Number	Andon Part Number Replace "XXX" with Terminal Type	Terminal Type		Pin Ø [in]	Figure Number	Page Number
		Thru-Hole	Surface Mount			
T1507	R280-SP05-02T-XXX-R27-L14	75S	265S	.018	1	1
T2111	R375-0804-01T-XXX-R27-L14	433E	285E	.040	2	1
T807	R200-0403-05T-XXX-R27-L14	01S	93S	.018	8	2
RPT7050P	606-06-SM-G10-L14-1	-	-	-	13	3
RPT7050A	606-06-SM-G10-L14-1	-	-	-	13	3
RPT7050J	606-06-SM-G10-L14-1	-	-	-	13	3
H(V)T700 SERIES	605-08-SM-G10-L14-1	-	-	-	14	3
7050C	605D-06B-SM-G10-L14-1	-	-	-	12	3
7050Q	605-08A-SM-G10-L14-1	-	-	-	15	3
ROX2525T5	C10-7524-05-01-XXX-R27-L14	295V	439V	.030	10	2
LND 100 PTH2	C10-14-05-02-XXX-R27-L14	295V	439V	.030	9	2
LNO 100 PTH3	C10-7524-05-01-XXX-R27-L14	295V	439V	.030	10	2
LNO 100 PTH1	C125-1018-05-01-XXX-R27-L14	295V	439V	.030	4	1
RFPO60/65-QEN55	C10-314-04-01-XXX-R27-L14	01S	93S	.018	7	2
ROX3827T3	C10-1016-07-01-XXX-R27-L14	295V	439V	.030	11	3
ROX5050T1	CSP1598-08-01-XXX-R27-L14	433E	285E	.040	3	1
ROX5141T1	CSP1260-05-02-XXX-R27-L14	433E	285E	.040	5	2
XO SERIES	C10-314-14-01-XXX-R27-L14	01S	93S	.018	6	2
DIL1	C10-314-14-01-XXX-R27-L14	01S	93S	.018	6	2
QEN49	C10-314-14-01-XXX-R27-L14	01S	93S	.018	6	2

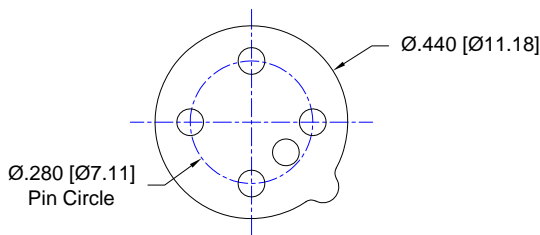

Fig. 01

Thru-Hole: R280-SP05-02T-75S-R27-L14
Surface Mount: R280-SP05-02T-265S-R27-L14

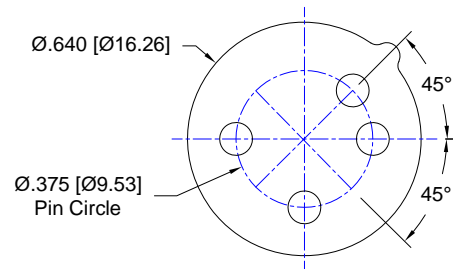

Fig. 02

Thru-Hole: R375-0804-01T-01S-R27-L14
Surface Mount: R375-0804-01T-93S-R27-L14

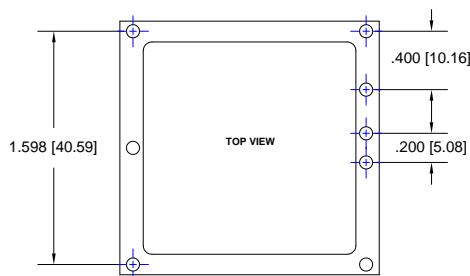

Fig. 03

Thru-Hole: CSP1598-08-01-433E-R27-L14
Surface Mount: CSP1598-08-01-285E-R27-L14

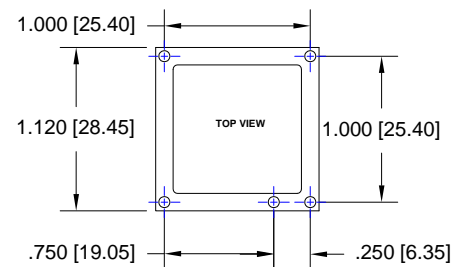

Fig. 04

Thru-Hole: C125-1018-05-01-295V-R27-L14
Surface Mount: C125-1018-05-01-439V-R27-L14

Rakon America LLC Continued
Socket Terminal Details
Cross Section View Shown Units: in [mm]

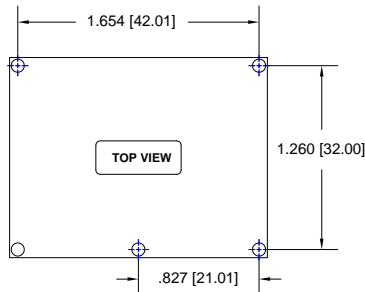

Fig. 05

Thru-Hole: CSP1260-05-02-433E-R27-L14
Surface Mount: CSP1260-05-02-285E-R27-L14

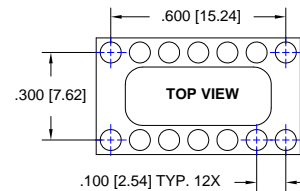

Fig. 06

Thru-Hole: C10-314-14-01-01S-R27-L14
Surface Mount: C10-314-14-01-93S-R27-L14

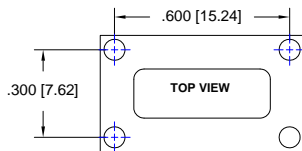

Fig. 07

Thru-Hole: C10-314-04-01-01S-R27-L14
Surface Mount: C10-314-04-01-93S-R27-L14

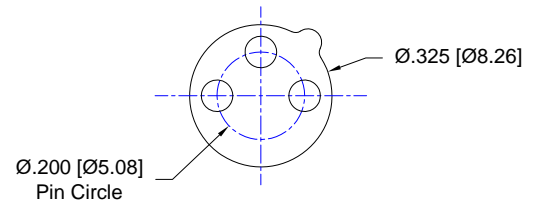

Fig. 08

Thru-Hole: R200-0403-05T-01S-R27-L14
Surface Mount: R200-0403-05T-93S-R27-L14

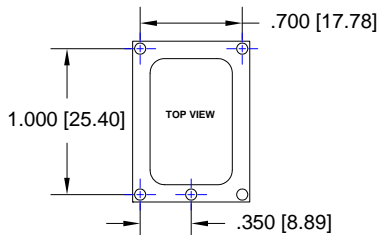

Fig. 09

Thru-Hole: C10-1014-05-02-295V-R27-L14
Surface Mount: C10-1014-05-02-439V-R27-L14

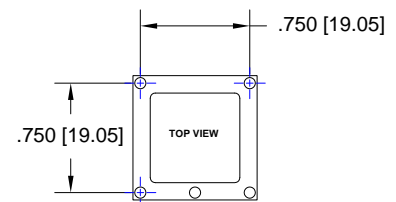

Fig. 10

Thru-Hole: C10-7524-05-01-295V-R27-L14
Surface Mount: C10-7524-05-01-439V-R27-L14

Rakon America LLC Continued
Socket Terminal Details
Cross Section View Shown Units: in [mm]

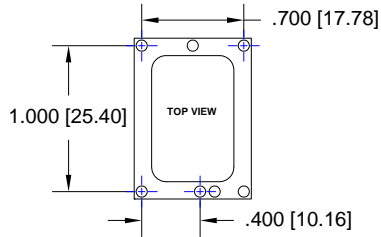

Fig. 11

Thru-Hole: C10-1016-07-01-295V-R27-L14
Surface Mount: C10-1016-07-01-439V-R27-L14

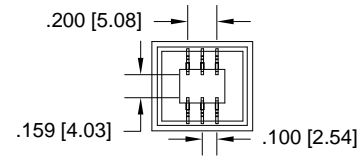

Fig. 12

Thru-Hole: N/A
Surface Mount: 605D-06B-SM-G10-L14-X

Replace "-X" with "-1" for index pins or "-0" for none

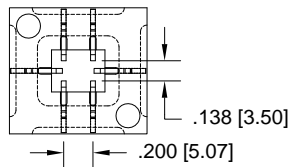

Fig. 13

Thru-Hole: N/A
Surface Mount: 606-06-SM-G10-L14-X

Replace "-X" with "-1" for index pins or "-0" for none

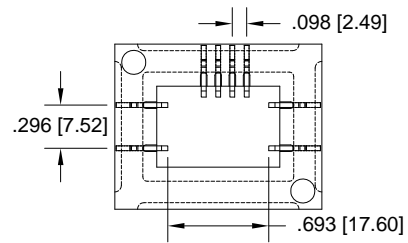

Fig. 14

Thru-Hole: N/A
Surface Mount: 605-08-SM-G10-L14-X

Replace "-X" with "-1" for index pins or "-0" for none

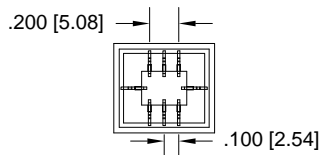

Fig. 15

Thru-Hole: N/A
Surface Mount: 605-08A-SM-G10-L14-X

Replace "-X" with "-1" for index pins or "-0" for none

Rakon America LLC *Continued*

Socket Terminal Details *Cross Section View Shown Units: in [mm]*

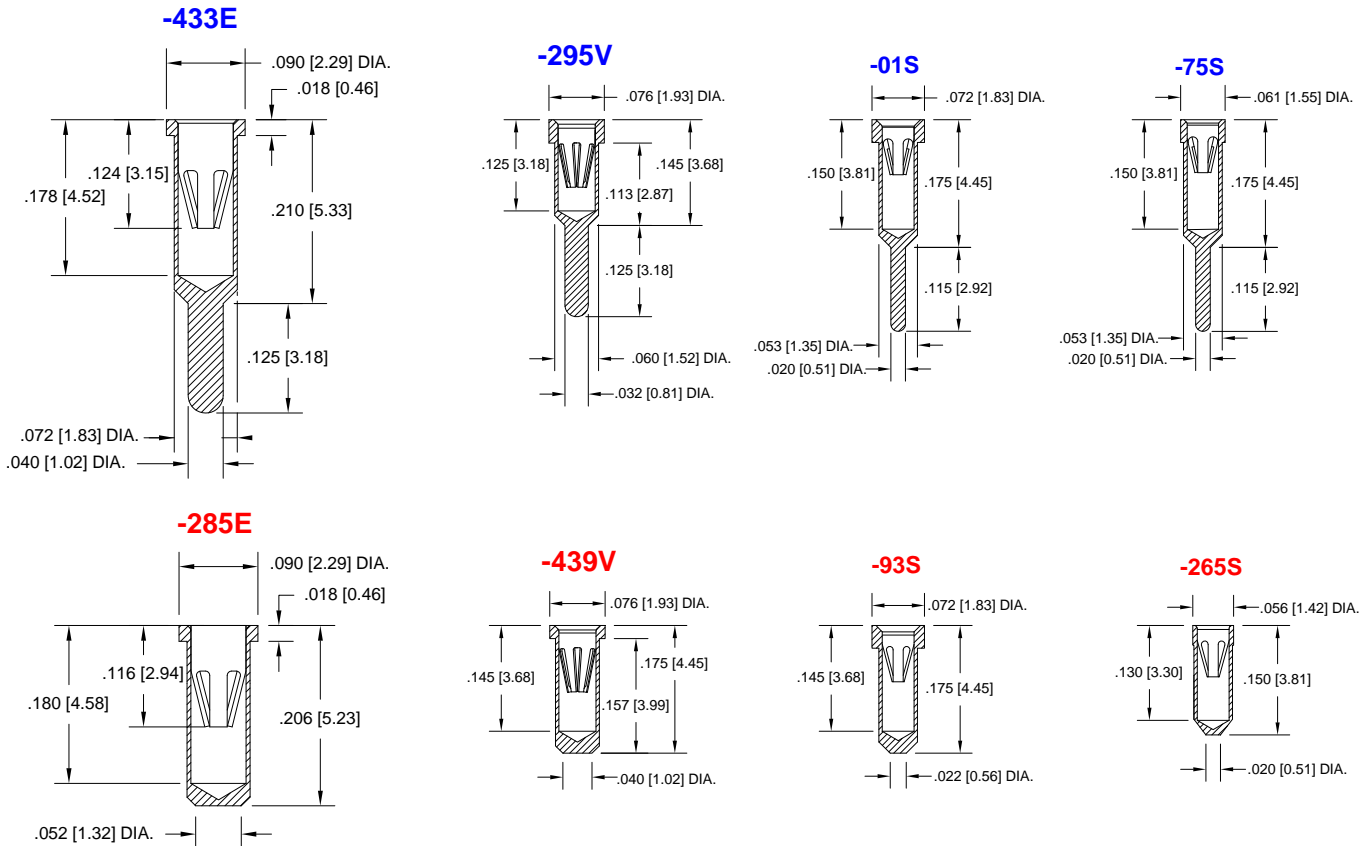

Technical Information

Material:

Insulator: Hi-Temp UL 94V-O
 Terminal: Brass, per ASTM-B16
 Contact: BeCu, Per ASTM-B194

Plating: RoHS COMPLIANT

R15 TERMINAL: GOLD / CONTACT: GOLD

R17 TERMINAL: TIN / CONTACT: GOLD

OTHER PLATINGS AVAILABLE

Terminal Acceptance and Forces

Thru Hole Terminals				Surface Mount Terminals			
Thru Hole Terminal	Accepts Pin Diameter	Insertion Force	Withdrawal Force	Surface Mount Terminal	Accepts Pin Diameter	Insertion Force	Withdrawal Force
-01S	Ø.018 [Ø0.46]	9.0 oz Avg.	2.0 oz Min	-93S	Ø.018 [Ø0.46]	9.0 oz Avg.	2.0 oz Min
-433E	Ø.040 [Ø1.02]	36.0 oz Max	3.9 oz Min	-285E	Ø.040 [Ø1.02]	36.0 oz Max	3.9 oz Min
-75S	Ø.018 [Ø0.46]	9.0 oz Max	2.0 oz Min	-265S	Ø.018 [Ø0.46]	9.0 oz Max	2.0 oz Min
-295V	Ø.030 [Ø0.76]	13.2 oz Max	3.5 oz Min	-439V	Ø.030 [Ø0.76]	13.2 oz Max	3.5 oz Min

MOUNTING OPTIONS

