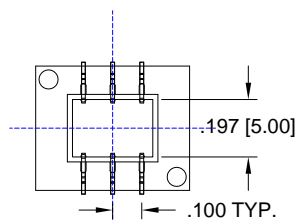


TGS (USA), INC.						
TGS (USA), INC. Model Number	Andon Part Number Replace "XXX" with Terminal Type	Terminal Type		Pin Ø [in]	Figure Number	Page Number
		Thru-Hole	Surface Mount			
VM75 SERIES	605D-06B-SM-G10-L14-X	-	-	-	1	1
OF SERIES	C10-1634-05-02-XXX-R27-L14	433E	285E	.040	18	4
T36	C10-1014-05-02-XXX-R27-L14	295V	439V	.030	11	3
OD SERIES	C10-1014-05-02-XXX-R27-L14	295V	439V	.030	11	3
T15A SERIES	C10-314-03-01-XXX-R27-L14	01S	93S	.018	9	3
T15B SERIES	C10-314-03-01-XXX-R27-L14	01S	93S	.018	9	3
F1	CSP291-04-02-XXX-R27-L14	400T4	414T4	.012	14	4
F2	CSP386-04-02-XXX-R27-L14	400T4	414T4	.012	16	4
F3	CSP197-04-01-XXX-R27-L14	400T4	414T4	.012	19	4
F4	CSP354-04-01-XXX-R27-L14	01S	93S	.018	17	4
F5	CSP528-04-01-XXX-R27-L14	01S	93S	.018	15	4
T20	C10-614-05-01-XXX-R27-L14	01S	93S	.018	2	2
OG SERIES	CSP866-05-01-XXX-R27-L14	433E	285E	.040	7	2
OE SERIES	C10-1020-04-01-XXX-R27-L14	295V	439V	.030	6	2
OC SERIES	C10-7524-05-01-XXX-R27-L14	295V	439V	.030	5	2
T14	C10-314-04-01-XXX-R27-L14	01S	93S	.018	3	2
OA14	C10-314-04-01-XXX-R27-L14	01S	93S	.018	3	2
CO14	C10-314-04-01-XXX-R27-L14	01S	93S	.018	3	2
CO8	C10-314-04-01-XXX-R27-L14	01S	93S	.018	3	2
CO8 SERIES	C10-7524-04-01-XXX-R27-L14	01S	93S	.018	4	2
OA8 SERIES	C10-7524-04-01-XXX-R27-L14	01S	93S	.018	4	2
V14 SERIES	C10-314-04-01-XXX-R27-L14	01S	93S	.018	3	2
V8 SERIES	C10-7524-04-01-XXX-R27-L14	01S	93S	.018	4	2
HC-49T	CSP192-03-01-XXX-R27-L14	01S	93S	.018	12	3
CS SERIES	CSP192-03-01-XXX-R27-L14	01S	93S	.018	12	3
CSS SERIES	CSP192-03-01-XXX-R27-L14	01S	93S	.018	12	3
UM 5	CSP148-03-01-XXX-R27-L14	C2	N/A	.018	13	3
CA SERIES	CSP148-03-01-XXX-R27-L14	C2	N/A	.018	13	3
CB SERIES	CSP148-03-01-XXX-R27-L14	C2	N/A	.018	13	3
CRT	C10-003-03-01-XXX-R27-L14	01S	93S	.018	8	3
CD10.7M	C10-003-03-01-XXX-R27-L14	01S	93S	.018	8	3
CU SERIES	CSP192-02-01-XXX-R27-L14	01S	93S	.018	10	3
CT SERIES	CSP192-02-01-XXX-R27-L14	01S	93S	.018	10	3
51U SERIES	C486-002-02-01-XXX-R27-L14	295V	439V	.030	20	4
CFA & CFB	C10-003-03-01-XXX-R27-L14	01S	93S	.018	8	3
CT SERIES	C10-003-03-01-XXX-R27-L14	01S	93S	.018	8	3
CDA & CDB	C10-003-03-01-XXX-R27-L14	01S	93S	.018	8	3
CRA	CSP192-02-01-XXX-R27-L14	01S	93S	.018	10	3
MG TYPE	CSP192-02-01-XXX-R27-L14	01S	93S	.018	10	3
MT & MX TYPE	CSP192-02-01-XXX-R27-L14	01S	93S	.018	10	3

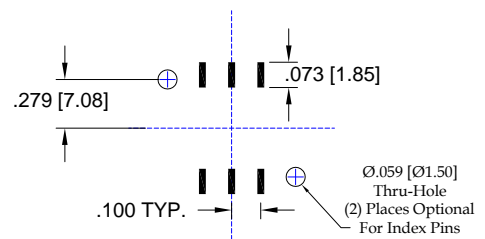


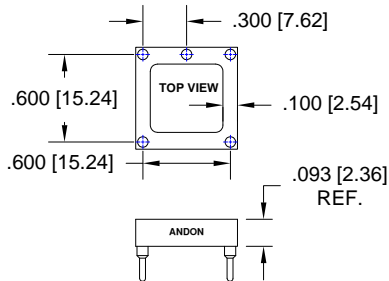
**Fig. 1**

Thru-Hole: N/A

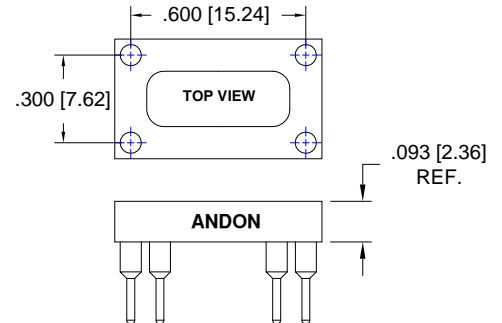
Surface Mount: 605D-06B-SM-G10-L14-X

WITHOUT INDEX PINS = -0  
WITH INDEX PINS = -1

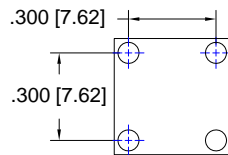




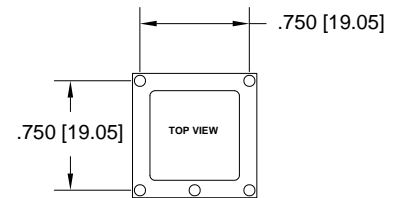
**Fig. 2**  
Thru-Hole: C10-614-05-01-01S-R27-L14  
Surface Mount: C10-614-05-01-93S-R27-L14



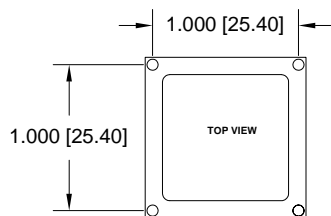
**Fig. 3**  
Thru-Hole: C10-314-04-01-01S-R27-L14  
Surface Mount: C10-314-04-01-93S-R27-L14



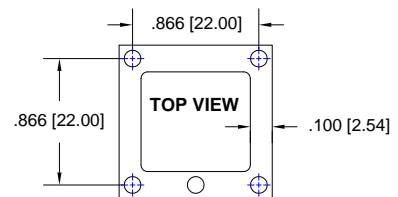
**Fig. 4**  
Thru-Hole: C10-7524-04-01-01S-R27-L14  
Surface Mount: C10-7524-04-01-93S-R27-L14



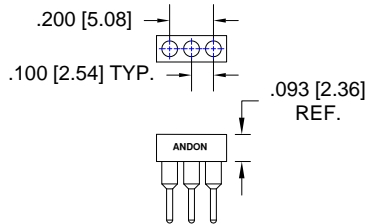
**Fig. 5**  
Thru-Hole: C10-7524-05-01-01S-R27-L14  
Surface Mount: C10-7524-05-01-93S-R27-L14



**Fig. 6**  
Thru-Hole: C10-1020-04-01-295V-R27-L14  
Surface Mount: C10-1020-04-01-439V-R27-L14

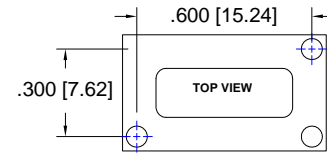


**Fig. 7**  
Thru-Hole: CSP866-05-01-433E-R27-L14  
Surface Mount: CSP866-05-01-439V-R27-L14



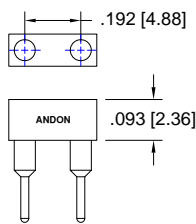
**Fig. 8**

**Thru-Hole:** C10-003-03-01-01S-R27-L14  
**Surface Mount:** C10-003-03-01-93S-R27-L14



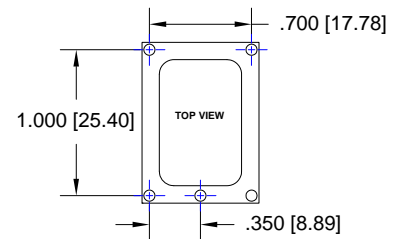
**Fig. 9**

**Thru-Hole:** C10-314-03-01-01S-R27-L14  
**Surface Mount:** C10-314-03-01-93S-R27-L14



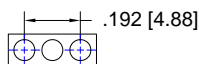
**Fig. 10**

**Thru-Hole:** CSP192-02-01-01S-R27-L14  
**Surface Mount:** CSP192-02-01-93S-R27-L14



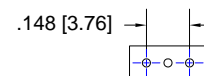
**Fig. 11**

**Thru-Hole:** C10-1014-05-02-295V-R27-L14  
**Surface Mount:** C10-1014-05-02-439V-R27-L14



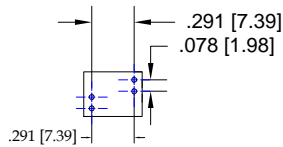
**Fig. 12**

**Thru-Hole:** CSP192-03-01-01S-R27-L14  
**Surface Mount:** CSP192-03-01-93S-R27-L14



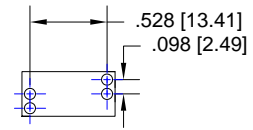
**Fig. 13**

**Thru-Hole:** CSP148-03-01-C2-R27-L14  
**Surface Mount:** N/A



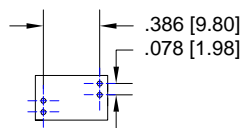
**Fig. 14**

**Thru-Hole:** CSP291-04-02-400T4-R27-L14  
**Surface Mount:** CSP291-04-02-414T4-R27-L14



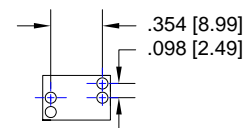
**Fig. 15**

**Thru-Hole:** CSP528-04-01-01S-R27-L14  
**Surface Mount:** CSP528-04-01-93S-R27-L14



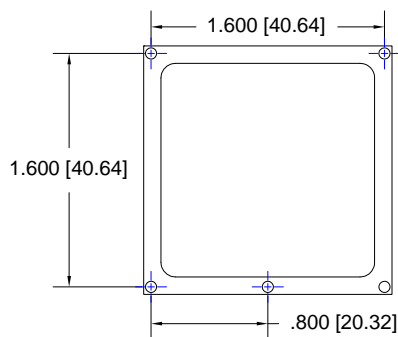
**Fig. 16**

**Thru-Hole:** CSP386-04-02-400T4-R27-L14  
**Surface Mount:** CSP386-04-02-414T4-R27-L14



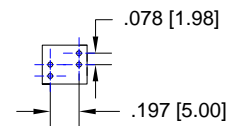
**Fig. 17**

**Thru-Hole:** CSP354-04-01-01S-R27-L14  
**Surface Mount:** CSP354-04-01-93S-R27-L14



**Fig. 18**

**Thru-Hole:** C10-1634-05-02-433E-R27-L14  
**Surface Mount:** C10-1634-05-02-285E-R27-L14



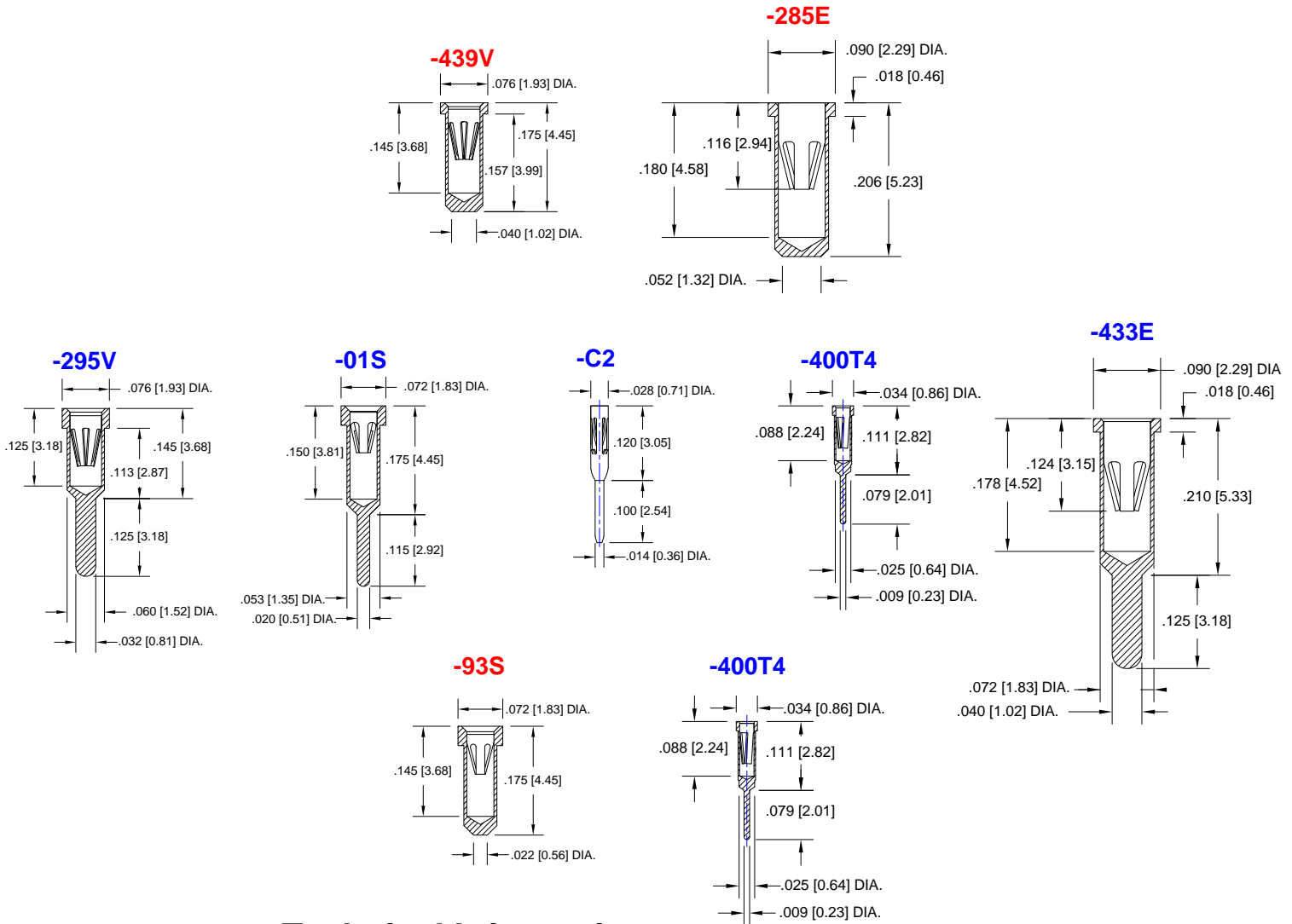
**Fig. 19**

**Thru-Hole:** CSP197-04-01-400T4-R27-L14  
**Surface Mount:** CSP197-04-01-414T4-R27-L14



**Fig. 20**

**Thru-Hole:** C486-002-02-01-295V-R27-L14  
**Surface Mount:** C486-002-02-01-439V-R27-L14



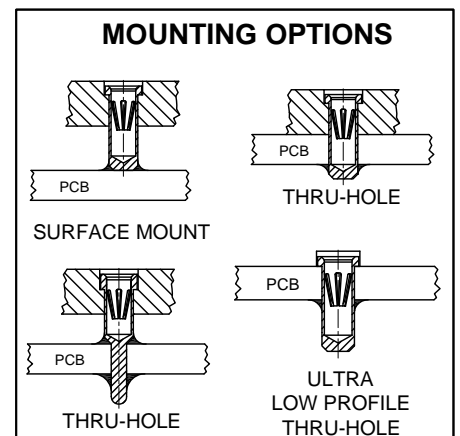
## Technical Information

### Material:

Insulator: Hi-Temp UL 94V-O  
Terminal: Brass, per ASTM-B16  
Contact: BeCu, Per ASTM-B194

### Plating: RoHS COMPLIANT

**R15 TERMINAL: GOLD / CONTACT: GOLD**  
**R17 TERMINAL: TIN / CONTACT: GOLD**  
**OTHER PLATINGS AVAILABLE**



Terminal Acceptance and Forces							
Thru Hole Terminals				Surface Mount Terminals			
Thru Hole Terminal	Accepts Pin Diameter	Insertion Force	Withdrawal Force	Surface Mount Terminal	Accepts Pin Diameter	Insertion Force	Withdrawal Force
-400T4	Ø.012 [Ø0.30]	1.1 oz Avg.	0.3 oz Min	-414T4	Ø.012 [Ø0.30]	1.1 oz Avg.	0.3 oz Min
-01S	Ø.018 [Ø0.46]	9.0 oz Avg.	2.0 oz Min	-93S	Ø.018 [Ø0.46]	9.0 oz Avg.	2.0 oz Min
-C2	Ø.018 [Ø0.46]	1.5 oz Avg.	0.04 oz Min	-N/A	-	-	-
-433E	Ø.040 [Ø1.02]	36.0 oz Avg.	3.9 oz Min	-285E	Ø.040 [Ø1.02]	36.0 oz Avg.	3.9 oz Min
-295V	Ø.030 [Ø0.76]	13.2 oz Avg.	3.5 oz Min	-439V	Ø.030 [Ø0.76]	13.2 oz Avg.	3.5 oz Min

©Copyright 2014 Andon Electronics Corporation. All Rights Reserved. This material is protected under US and other copyrights and may not be copied, sold, or redistributed in any form without written permission of Andon Electronics Corporation. Copyrights and trademarks are property of their respective companies. We reserve the right to change specifications without notice. Andon makes no warranty, expressed or implied, as to the suitability of the sockets for the intended purpose.

**"ANDON PROPRIETARY INFORMATION"**  
**RoHS Compliant**  
\*Sockets are not drawn to scale TGS (USA), INC. 12/19/2014